

SUPPLY^{as} LINE)))

Makes containers smart
and chemical handling safe.

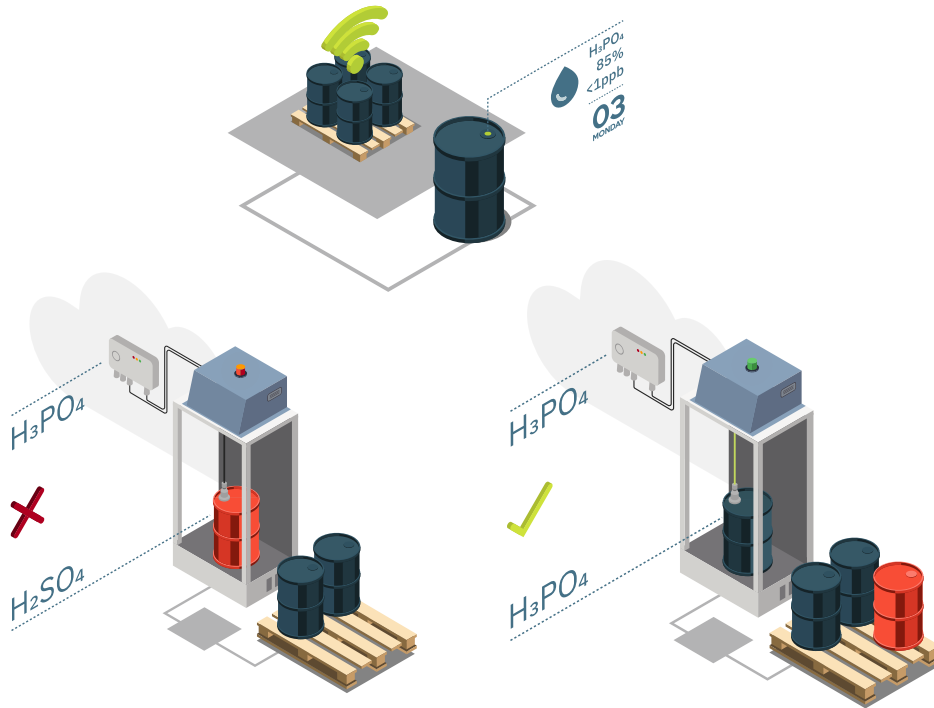



For Suppliers

→ Story

and



For Customers

→ Story

Twice the Safety

without additional effort - completely automatically



AS assigns a digital chemical key code to all dip tubes in addition to the mechanical coding.

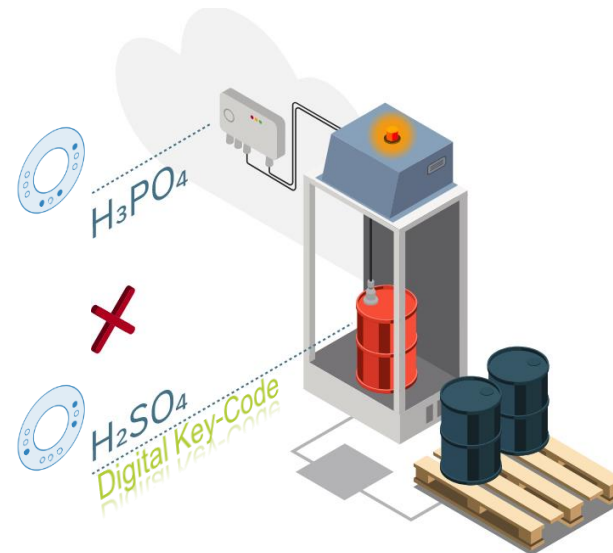

Prevents accidents automatically
for Suppliers and End Customers

The advantage of RFID dip tubes: The chemical code can be checked at any time at filling or dispensing stations - at the supplier's as well as the end customer's premises, independently of each other and regardless of who in the supply chain is already working with SupplyLine!

Chemical, Batch and Container-Data

simply added



Lifecycle

Chemical

Batch

Chemicals

BRAND® Sulfuric Acid 98% / SLSI / Customer 1

×

▼

SET CHEMICAL TO ALL

5 RFID-Chips scanned

	Chemical Uncoded	×
	Chemical Uncoded	×
	Chemical Uncoded	×
	Chemical Uncoded	×
	Chemical Uncoded	×

Chemical, Batch and Container-Data simply added

Chemical
individually added
including Concentration,
Quality, Customer / Supplier

Container Lifetime
visual feedback

Dip Tube Details →

Data

History

RFID-Chip
01001F000010DE73

Dip Tube Lifetime
10/2022

Chemical
BRAND® Sulfuric Acid 98% / SLSI / Customer 1

Batch no.
230622A

Installed

Container

Container S/N
123456

Container Inspection
08/2022

Container Lifetime
02/2024

Batch
manually or automatically
assigned during filling

Container Serial no.
added via barcode

© 2022 AS Strömungstechnik GmbH. All rights reserved.

Prevents Accidents during filling and emptying

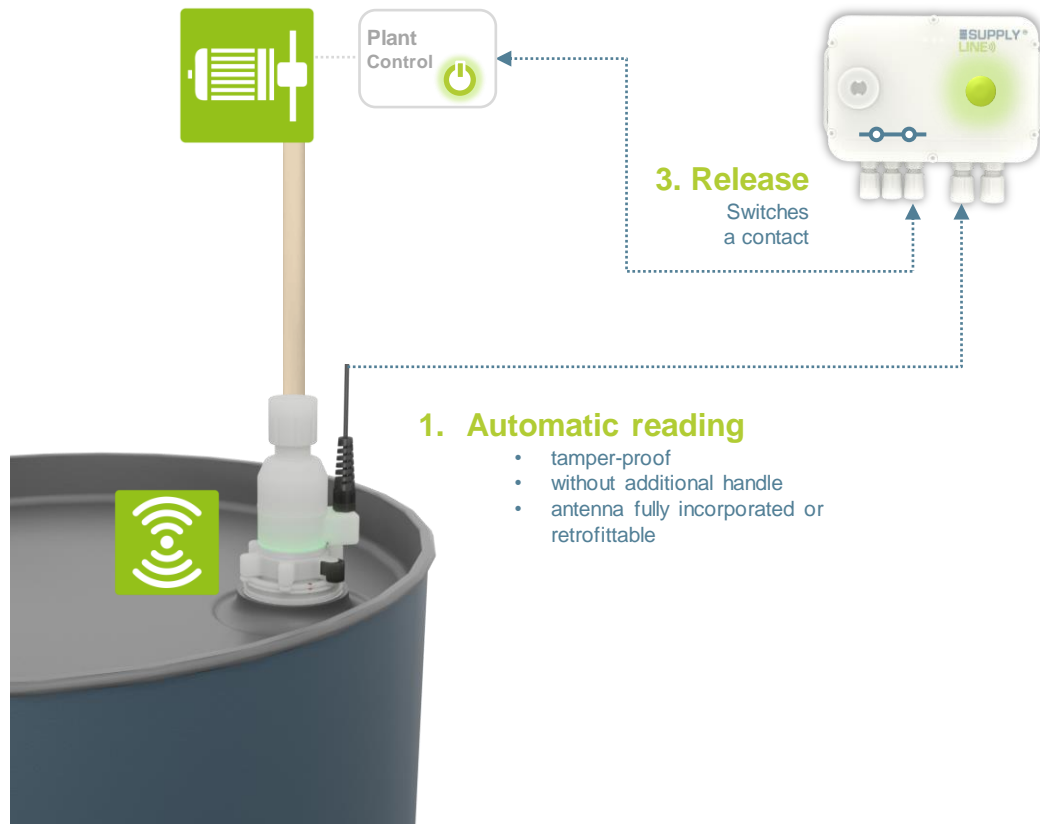

2. Real time verification

- ✓ **Chemical / Quality / Concentration / Customer / Supplier**
if container and station match
- ✓ **Container lifetime and inspection date**
are not exceeded (during filling)
- ✓ **Chemical Batch**
can automatically be assigned and documented

* The Gateway does not exchange any data with the local plant control system and is therefore as easy to integrate as a standard sensor or switch.

Prevents Accidents during filling and emptying



1. Automatic reading

- tamper-proof
- without additional handle
- antenna fully incorporated or retrofittable

2. Real time verification

- ✓ **Chemical / Quality / Concentration / Customer**
if container and station match
- ✗ **Container lifetime and inspection date**
are exceeded
- ✓ **Chemical Batch**
can automatically be assigned and documented

* The Gateway does not exchange any data with the local plant control system and is therefore as easy to integrate as a standard sensor or switch.

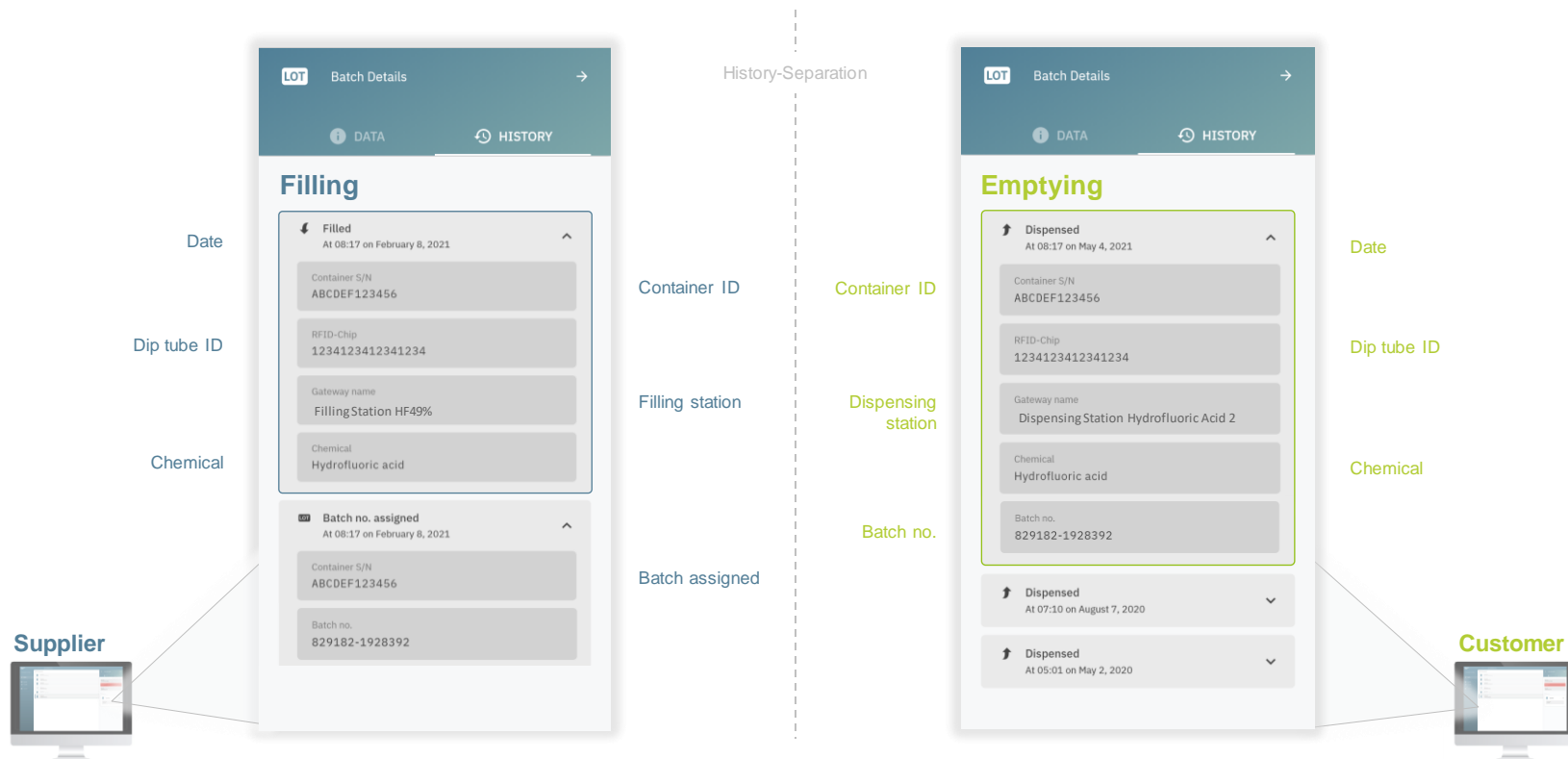

* Only you have access to the history events you record.
You can determine yourself whether the history feature should be activated for your account.

Dip tube and Container History for Suppliers

Number of fillings

How often was my container filled?

Installation date dip tube

Since when is my dip tube installed?



Dip Tube Details

Data

History

Times refilled: 7 fillings

Chemical contact: 44 days

Dip tube Installed: 94 days

Dip tube installed

At 19:04 on June 23, 2022

Container S/N 123456

Dip tube removed

At 12:00 on June 24, 2022

Dip tube installed

At 12:00 on June 24, 2022

68 days

Time in chemical contact

How long was my container filled?

Dip tube change

In which containers was my dip tube installed?

* Only you have access to the history events you record.
You can determine yourself whether the history feature should be activated for your account.

Dip Tube and Container Overview for Suppliers



TEST@MAIL.COM ▾

- Scanner
- Gateways
- Data
- Dip Tubes
- Chemicals
- Batches
- CONNECT
- Contact Us

Dip Tubes

Dip Tube configurations and settings

Q 2270195B|

Dip Tube S/N	Container S/N	Dip Tube Lifetime	Container Lifetime	Container Inspection	Chemical	Batch no.
227ABC01	ABCDEF12350	24 months	24 months	12 months	Hydrofluoric acid	829182-15
227ABC02	ABCDEF12351	24 months	24 months	12 months	Hydrofluoric acid	829182-15
227ABC03	ABCDEF12352	24 months	24 months	12 months	Hydrofluoric acid	829182-15
227ABC04	ABCDEF12353	24 months	24 months	12 months	Hydrofluoric acid	829182-15
227ABC05	ABCDEF12354	20 months	20 months	8 months	Hydrofluoric acid	829182-15
227ABC06	ABCDEF12355	20 months	20 months	8 months	Hydrofluoric acid	829182-15
227ABC07	ABCDEF12356	20 months	20 months	8 months	Hydrofluoric acid	829182-15
227ABC08	ABCDEF12357	20 months	20 months	8 months	Hydrofluoric acid	829182-15
227ABC09	ABCDEF12358	16 months	16 months	4 months	Hydrofluoric acid	829182-15

Dip Tube Details

DATA HISTORY

Dip tube installed: 94 days

Filled
At 09:55 AM on October 14, 2022

Container S/N
ABCDEF12355

Dip tube S/N
227ABC06

Gateway name
Filling Station Hydrofluoric Acid

Chemical
Hydrofluoric Acid

Batch no. assigned
At 09:17 AM on October 14, 2022

Container S/N
ABCDEF12355

Batch no.
829182-1928397

Dip tube installed
At 19:04 on June 23, 2022

Container S/N
123456

- Forecast how many containers and dip tubes will expire soon
- Timely replacement
- 100% traceability for each dip tube and container

* Only you have access to the history events you record and to the dip tubes you own.
You can determine yourself whether the history feature should be activated for your account.

Works with all Containers

even without dip tube

Fully incorporated
in dip tube



Seperately
attached to container

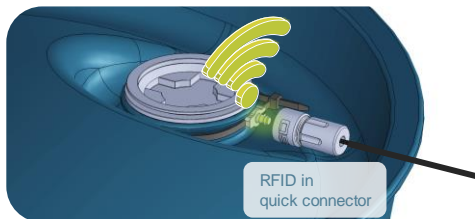

Retrofitted
to tank quick connect



Existing Fill / Dispense Heads
RFID Antenna to retrofit

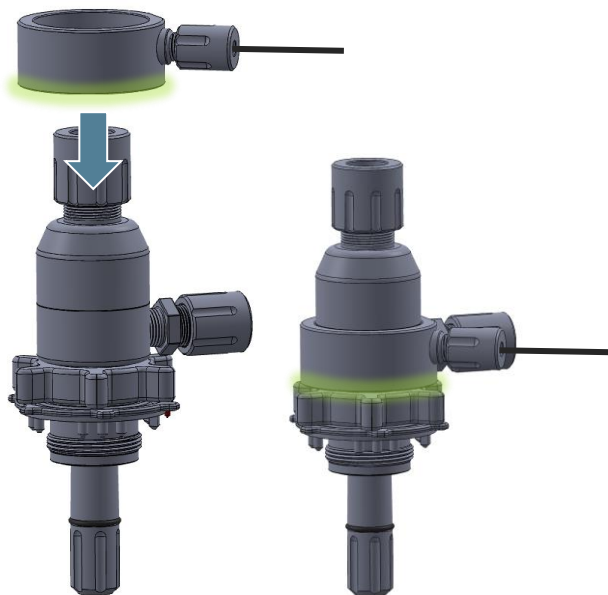

Filling not via dip tube?
Check RFID chip anyway

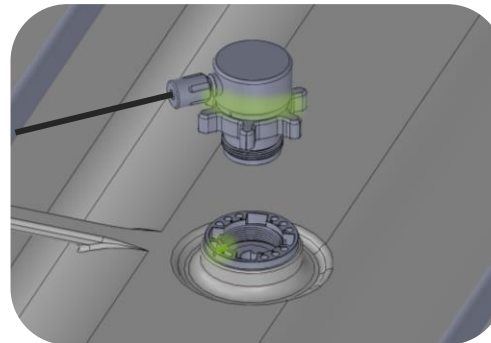

Adapter with RFID
antenna for quick
connection to dip
tube during filling
via separate
container opening

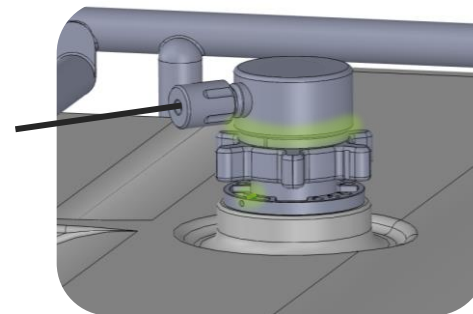

Hang it up, Plug it in and Go!

SupplyLine “Starter-Kit”



The diagram illustrates the components of the SupplyLine Starter Kit and their interconnections. At the top left, a 'SupplyLine®-Gateway' unit is shown with three status lights (green, yellow, red) and a 24V power input. A '24V' label with a plug icon is connected to the gateway. Below the gateway, a 'Fill / Dispense Head' is shown with an integrated RFID antenna. To the right of the gateway, a handheld 'RFID Reader' is depicted. Further right, a 'Router' is shown, noted as an alternative to a corporate network. A central text box with a mouse cursor pointing to it reads 'Test for yourself Free of Charge'.

1. SupplyLine®-Gateway

- Large signal light shows if everything is correct!
- Plug-and-play
- 100% protected against chemical vapors

3. Fill / Dispense Head
RFID antenna incorporated or separately for retrofitting

3. RFID Reader
easy assignment and readout of data

4. Router
as an alternative to the corporate network

Test for yourself
Free of Charge



SupplyLine Web-App

- Immediately ready for use without any installation
- Accessible via any web browser



RFID in Dip Tube

Preinstalled as a standard with digital chemical code



Do you need more information?

Please don't hesitate to contact me directly.



Nico Fischer

Business Development Manager
n.fischer@asstroemungstechnik.de
+49 (0) 711 220548-19